

Electronic step-on step-off relays SR-2

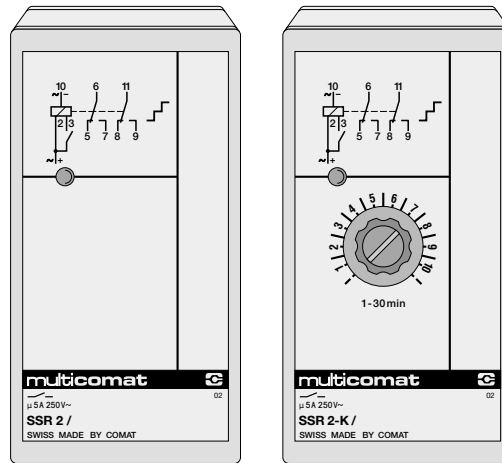

Electronic step-on step-off relays type SR-2 with the following characteristics:

- Plug in step-on step-off relay with supply voltage control and 2 change-over contacts 5A, 250V~
- Suitable for standard 11 pin base as specification IEC 67-1-18a
- Type SSR 2 without memory
- Type SSR 2-K with time delay function, specifically designed for lighting control
- LED display on all models of relay function

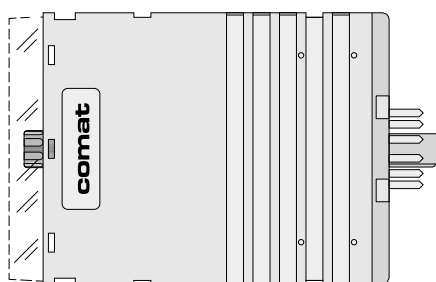

Type	Time range
SSR 2-K	1 – 30min

Voltages, current consumption, type				
⚡	AC 50/60 Hz/UC		Version	Ordering no.
	U min – U max	I max		
AC 220V~	185 – 245V	8 mA	with mains transformer	SSR 2-K/AC220V~
UC 24V≈	20 – 29V	55 mA		SSR 2-K/UC24V≈

Example of order: 1 step-on step-off relay SSR 2-K/AC220V

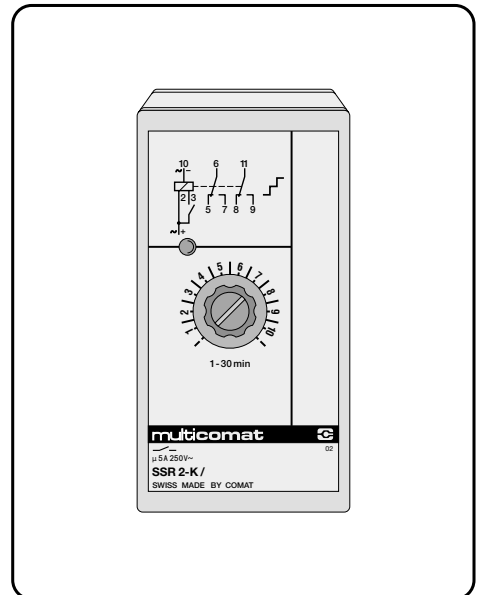

Functions	Diagram	Description	Scheme
Step-on step-off		S ⇒ R on or off	①
Step-on step-off with one shot leading edge		S (pulse or continuous contact) ⇒ R on for t S on for t ⇒ R off	②
One shot leading edge		S (pulse or continuous contact) ⇒ R on for t S --- does not influence R and t	③

ON OFF S = triggering ⇒ = switches... R = output circuit

Diagram	
Connection with socket CS-11	

Connection scheme	
Connection with socket CS-11	
Step-on step-off without timing mode	①
Step-on step-off with timing mode	②
Only timing mode	③

Neon switch current max. 50mA (at 220-240V~).

Technical data	General
Repeat accuracy ¹⁾	± 2% oder 20ms
Voltage stability	± 1% ²⁾
Temperature stability	0,1%/°C
Time range tolerance max.	-0 +20%
Reset time	100ms
Triggering time	≥ 40ms
Triggering delay time	15...40ms
Load of control contact S	6mA (75mA) ³⁾
Operating temperature range	-25... +60°C
Storage temperature range	-25... +80°C
Transient voltage protection	3kV, 50µs
Specifications/Standards	SEV, VDE 0435/0110 Gr. C
Protection/Case material	IP 40/Noryl SE1 to UL 94 V-1
Weight incl. packing	approx. 150g, with transformer approx. 250g

¹⁾ referred to the set time ³⁾ 220V execution
²⁾ max. tolerance total Data at T_{amb} = 25°C and V_{nom}

Technical data	Output circuit
Switching current max.	5A
Switching voltage max.	250V~ AC 1
Breaking capacity	AC: 1200VA; DC: ...250W
Mechanical life	2x10 ⁷ operations
Contact material	Ag Ni

These values are valid for ohmic load or for inductive loading with spark arrest.

Dimensions	Case S2

Front mounting accessory FZ-23 (front panel aperture: 38,5x70^{+0,5} mm, front panel thickness max. 3mm). Transparent front cover FS-23 (part of the scope of delivery).

C11A Relay socket with screw, connections for panel or DIN mounting-snap fit

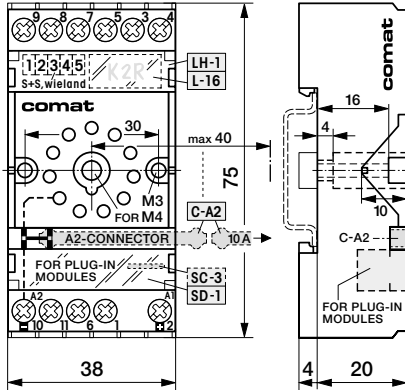

EC-11 Relay socket with screw, connections for panel or DIN mounting-snap fit

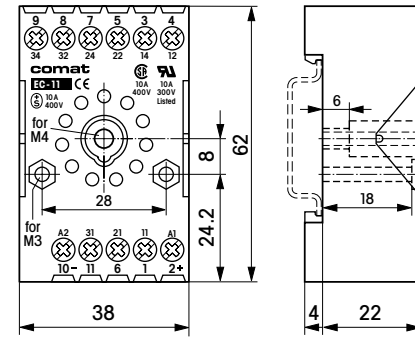

CS-11 Relay socket with screw, connections for panel or DIN mounting-snap fit

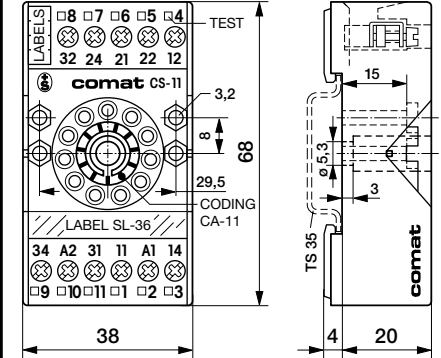

11 PGF Relay socket for fasten connectors (2xAMP 2,8x0,8 DIN 46247)

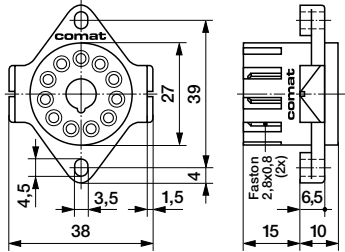

11 PGL Relay socket for chassis mounting (solder tags: 3,8x0,8 mm)

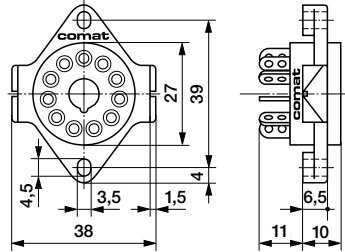

RG-23 Surface mounting case with built-in relay socket (protected connection terminals)

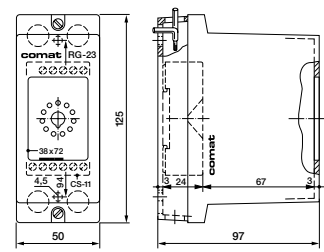

HF-24 Retaining clip for cases S2, S3, S4 suitable for all relay sockets

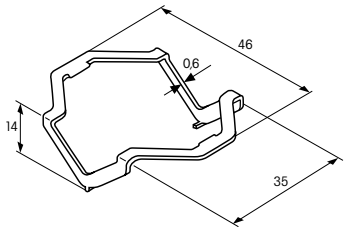

FS-23 Transparent cover (always included with the relay)

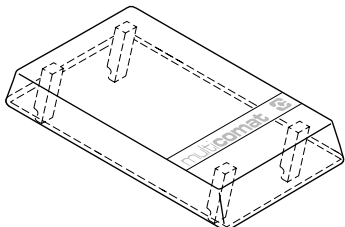

FZ-23 Front of panel mounting accessory comprising 2 front frame parts ① and 2 retaining clips ②

